

innuPREP DOUBLEpure Kit

Protocol: Purification and concentration of PCR products

-
1. Starting material
- PCR reaction mix
 - Up to 50 μ l
-

2. Binding of PCR Fragments

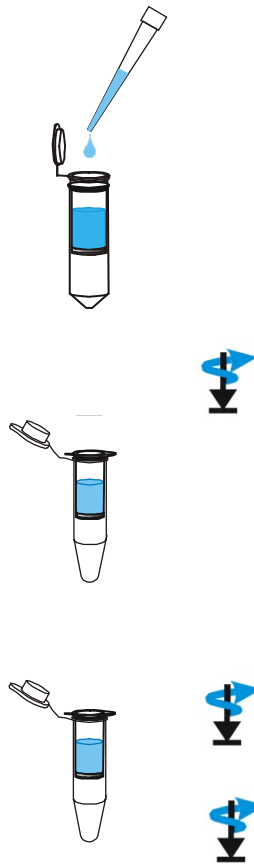

- Add Spin Filter to Receiver Tube
- Add 500 μ l Binding Buffer to Spin Filter
- Add PCR reaction mix to Spin Filter
- Mix: up and down pipetting

Alternative:

- Add 500 μ l Binding Buffer to PCR reaction mix, Vortex
- Add Spin Filter to Receiver Tube
- Add mixed sample to Spin Filter
- 11,000 x g (~11,000 rpm): 3 min

Maximum purity:

- Two-step centrifugation
- 11,000 x g (~11,000 rpm): 1 min
- Discard flow through
- 11,000 x g (~11,000 rpm): 2 min

-
3. Elution

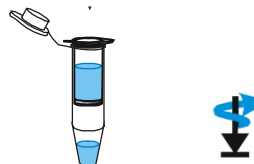

- Add Spin Filter to an Elution Tube
 - Add minimum 10 μ l Elution Buffer to center of the Spin Filter
 - Incubation: 1 min @ RT
 - 11,000 x g (~11,000 rpm): 1 min
-

Order No.:	845-KS-5050010	10 reactions
	845-KS-5050050	50 reactions
	845-KS-5050250	250 reactions

This documentation describes the state at the time of publishing. It needs not necessarily agree with future versions. Subject to change!

Expression and further use permitted with indication of source. © 2021 Analytik Jena GmbH, AJ Innuscreen GmbH

Analytik Jena GmbH
Konrad-Zuse-Straße 1
07745 Jena
Germany

Phone +49 3641 77 9400
Fax +49 3641 77 767776
info@analytik-jena.com
www.analytik-jena.com

Manufacturer:
AJ Innuscreen GmbH
Robert-Rössle-Straße 10
13125 Berlin